

Cypress City Center

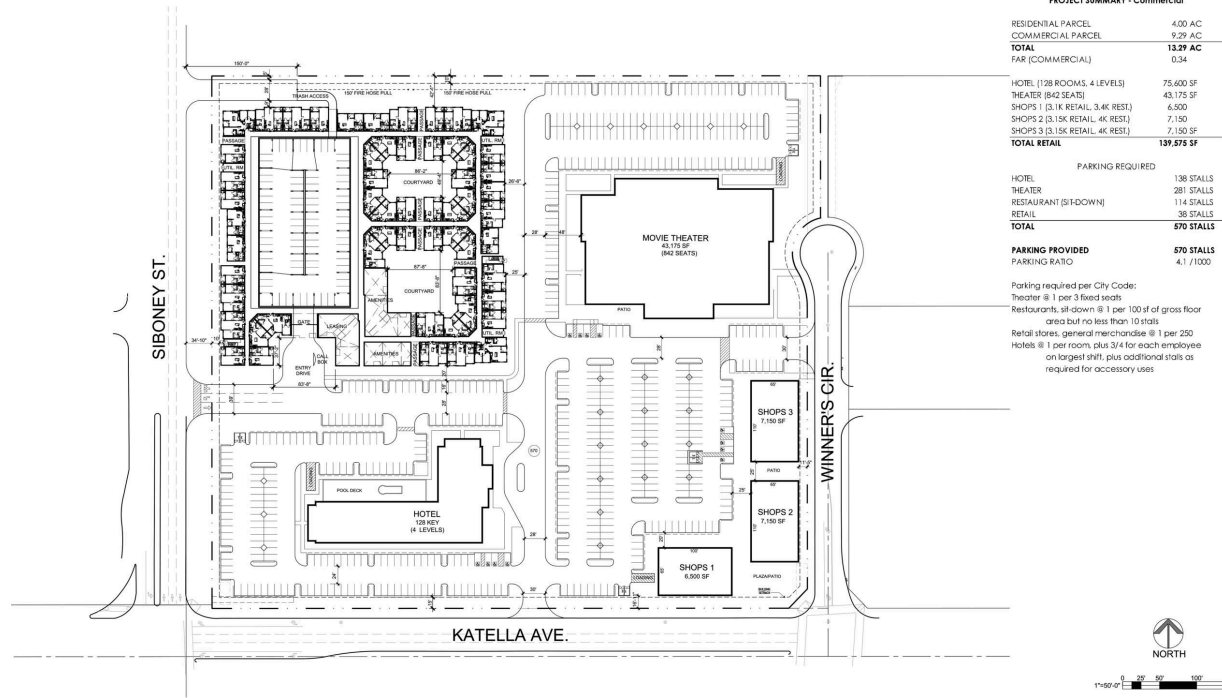

PROJECT SUMMARY - Commercial

RESIDENTIAL PARCEL	4.00 AC
COMMERCIAL PARCEL	9.29 AC
TOTAL	13.29 AC
FAR (COMMERCIAL)	0.34
HOTEL (128 ROOMS, 4 LEVELS)	75,600 SF
THEATER (842 SEATS)	43,175 SF
SHOPS 1 (3,15K RETAIL, 4K REST.)	6,500
SHOPS 2 (3,15K RETAIL, 4K REST.)	7,150
SHOPS 3 (3,15K RETAIL, 4K REST.)	7,150 SF
TOTAL RETAIL	139,875 SF

PARKING REQUIRED	
HOTEL	138 STALLS
THEATER	281 STALLS
RESTAURANT (SIT-DOWN)	114 STALLS
RETAIL	38 STALLS
TOTAL	570 STALLS
PARKING PROVIDED	570 STALLS
PARKING RATIO	4.1 / 1000

Parking required per City Code:
 Theater @ 1 per 3 fixed seats
 Restaurants, sit-down @ 1 per 100 sf of gross floor area but no less than 10 stalls
 Retail stores, general merchandise @ 1 per 250
 Hotels @ 1 per room, plus 3/4 for each employee on largest shift, plus additional stalls as required for accessory uses

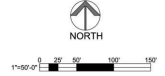

CYPRESS MIXED-USE DEVELOPMENT CYPRESS, CA
 SHEA PROPERTIES
 130 Vantis, Ste. 200, Aliso Viejo, CA 92656
 (949) 389-7200

3-SHOP BLDG OPTION

DATE: 05-29-19
 JOB NO.: 2018-344
ARCHITECTS ORANGE
 144 NORTH ORANGE ST., ORANGE, CA 92866
 (714) 639-9860

